



THE MK 2 LIMPET™ ALARM

INSTRUCTIONS APRIL 2008

Products Proudly



Can also be incorporated into a Central Alarm System, AMX®, Crestron® or Aurora® Controllers

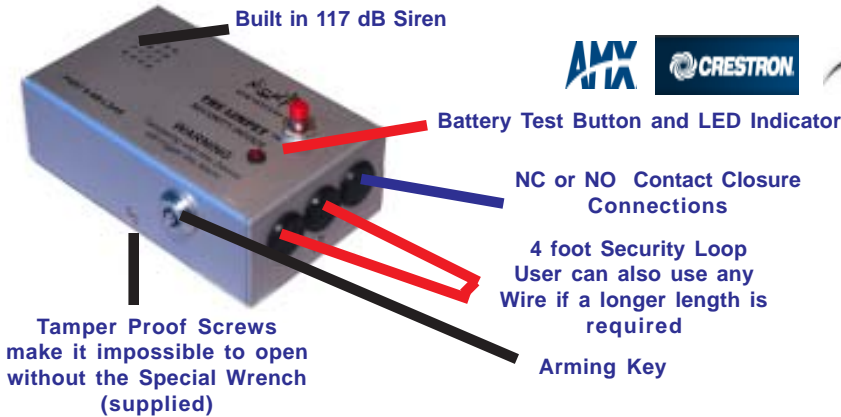

Loop Keep made of Case Hardened Steel to Rockwell 60 +. Hacksaw Blade slides straight off

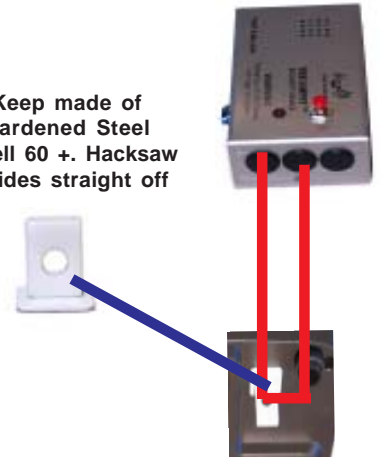

The Loop Wire exits the Limpet and is then passed through the Keep Plate & returned to the Limpet

There are many different types of Equipment that the Limpet will Protect

1. Static Displays of High Value Equipment.
 2. Flat Screen Monitors
- Are two of the most obvious uses

For Projectors, the cost benefits installing the Limpet include:

1. Elimination of the Inconvenience factor of being without the Device
2. Eliminates Unnecessary Insurance claims
3. Reduced Insurance Premiums.

CUSTOMABLE CONFIGURATIONS

1. Siren, Loop & NC Contact
2. Silent, Loop and NO Contact .
3. Loop Only.

NO FALSE ALARMS EVER

Silent Mode but connected to a Central Alarm System, AMX®, Crestron® or Aurora® Controllers is useful when you don't want to alert the thief that the Limpet has been activated.

SHOWN BELOW ARE TWO METHODS USED TO PROTECT PROJECTORS



3. Permanently Bonded to the Projector using the supplied Welding Adhesive



4. Bolted to a Permanent Fixture of the Building (Screws or Bolts are Hidden once the Limpet is closed up)

THE LIMPET CAN BE ATTACHED TO ANY SURFACE USING CONCEALED SCREWS, BOLTS OR THE PLASTIC WELDER

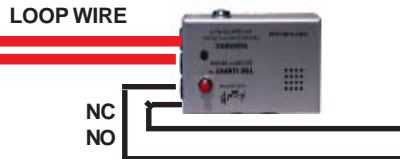

NORMALLY CLOSED OR NORMALLY OPEN ALLOW CONNECTIONS TO BE MADE TO ANY SECURITY SYSTEM, AMX®, CRESTRON® OR AURORA® CONTROLLERS

FOR FLAT SCREEN MONITORS OR OTHER HIGH VALUE ITEMS

The above examples shown for protecting Projectors are just as Effective when used with many different types of Equipment.

Please turn over for complete Installation Instructions

10 Year 9 V Battery

WARNING
Once Armed, Cutting, Jumpering or Removing the Loop or Contact Wires, sets off the alarm. The Limpet can only be deactivated using the Supplied Key

NO or NC Contact Closures for Connection to any Contact Closure Device.

Central Burglar System, AMX® Crestron® Control Devices, or Video Cameras etc.

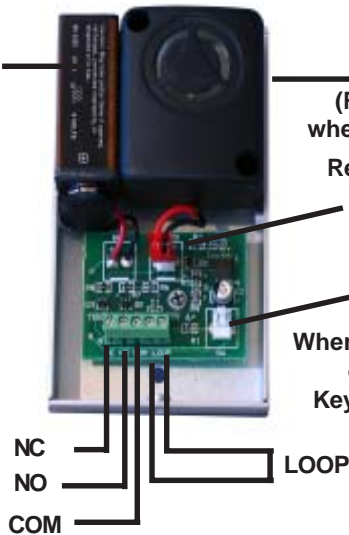

Products Proudly



Optional Mounting Holes (If not using the supplied Glue)

PLEASE NOTE

The Loop Wire consists of 4 Conductor Wires. The Installer chooses only one of the four to form the Loop. The idea of 4 different Wires is to make it more difficult for a thief to chose the actual wire to cut.

The User can also use any Wire or Length for the Loop, depending on the needs of the actual installation

GENERAL INSTRUCTIONS

1. Remove the cover's (4) 4.40 Tamper Proof Screws. using the T8 Tamper Proof Hex Key.
2. Form a Loop with the Supplied 4 ft Cable, or use your own. (See Note)
3. If using our Loop wire, select either Red, Black, Green or White Wire.
4. Make a hole in the Grommets to allow the Wire to pass through.
5. With the selected Colored Wire, connect the formed Loop to the Euro Connection (See Below if using the Keep Method).
6. You can either cut or discard the other Wires as they are not needed.

When you are using a Contact Connection.

1. Determine if you want NC or NO Closure Connection or both.
2. Select the Wire you want to use, and connect it to the Euro connector on the Circuit Board
3. Make a hole in the Grommet to allow the Wire to pass through.

(If you do not want to use the Built in Siren, simply remove the Red Plug).

If you want to mount the Limpet using Screws or Bolts.

1. Remove the 2 Pan Head Screws that holds the Piezo Siren down.
2. Screw or Bolt the Limpet to a Fixed Part of the Structure or to the Device.
3. Replace the Piezo Alarm.
4. Install the Battery.
5. Replace the Cover.
6. Arm the Unit with the Supplied Key once it is Glued or Bolted .

TWO METHODS OF USING THE LIMPET TO PROTECT THE DEVICE

THE KEEP METHOD.

1. Spead a small amount of Plastic Welder to the Keep.
2. Immediatly Press and clamp the Keep to the Device.

DEVICE METHOD

1. Spread a small amount of Plastic Welder to the Limpet.
2. Immediatly Press and clamp the Limpet to the Device.

THE PLASTIC WELDER-A WARNING

Plastic Welder is a Bonding Medium used to "weld" the Limpet or Keep to any device that needs to be protected. Once Bonded the user should be aware that it is almost impossible to remove the devices that have been bonded. For this reason the Keep Method should be used if removal of the Projector or Device is contemplated.

REPLACEMENT BATTERIES & PARTS

Replacement Batteries are available from Most Hardware Stores including ACE, True Value etc, under the Brand Name, Ultalife or 10 Year 9v Battery. Replacement Loop Wire or Keys etc., are freely available from us at reasonable cost.

SPECIFICATIONS

Built in Siren: 117 db
Current Consuption: 1000th of 1 mAmp
Battery: 10 Year Ultralife 9v Lithium
Dimensions 4" x 2" x 1.5". Weight: Less than 7ozs

SUPPLIED PARTS

-  Hardened Steel Loop Keep
-  T8 Tamper Proof Key
-  4 ft Loop Wire
-  10 Year 9 Volt Lithium Battery
-  Two Special Pattern Arming/Disarming Keys
-  One Tube Plastic Welder

FOR SECURITY REASONS

We deliberately chose components that cannot compromise the security aspects of the Limpet™ such as the Arming Key and Tamper Proof Screw Hex Key. Thieves will find it impossible to find these in any Hardware Store.